

# ALUMINUM BLINDS

## Product Specifications Guide



ALTA



---

## DOCUMENT USE

---

This document provides detailed product specifications only. Pricing information is now published separately in the Alta US Price Guide. (This guide was formerly known as the Retail Price List & Product Info Guide, which previously included both specifications and pricing.)

---

## SUMMARY OF REVISIONS

---

**1-20-2026 Revisions:**

Various Pages .....Pricing information moved to the Alta US Price Guide

---

# TABLE OF CONTENTS

---

## Features And Options

- Color Chart. . . . . 2

## Product Information

- Features and Options. . . . . 3
- Product Specifications . . . . . 4
- Cordless Lift & Lock™ Bottomrail Color Chart. . . . . 5

### **Oversize Common Carrier Delivery**

All orders with any quantity of shades or blinds or any continuous valance 90" or more in width are considered oversize. Therefore, a net shipping charge per oversized unit will be assessed.

Oversized orders that require expedited shipping will be quoted and charged accordingly.

Please see General Information for additional freight and shipping charge information.

## COLOR CHART

**Essentials  
Collection**

**Prime  
Collection**

**Macro  
Collection**

SOLID FINISHES			
COLOR NAME	1" .006 GAUGE	1" .008 GAUGE	2" .008 GAUGE
Alabaster	G6-002	G8-002	M2-002
Antique	G6-973	G8-973	M2-973
Beige	G6-186	G8-186	-
Black	G6-048	G8-048	M2-048
Canvas	G6-830	G8-830	M2-830
Cashmere	G6-997	G8-997	-
Chalk White	G6-885	G8-885	M2-885
Dark Bronze	G6-994	G8-994	M2-994
Evening Snow	-	G8-385	-
Malibu Sand	G6-316	G8-316	-
Mercury	G6-276	G8-276	M2-276
Mushroom	G6-365	G8-365	M2-365
Pearl	G6-974	G8-974	M2-974
Pebble	G6-999	G8-999	-
Pewter Gray	G6-405	G8-405	-
Polar Bear	G6-116	G8-116	M2-116
Pure White	G6-125	G8-125	-
Raw Umber	G6-887	G8-887	M2-887
Sand	G6-310	G8-310	M2-310
Seattle Gray	G6-860	G8-860	-
Smokey Gray	G6-443	G8-443	-
Squirrel Gray	G6-998	G8-998	M2-998
U.N. Gray	-	G8-870	M2-870
Vanilla	-	G8-148	M2-148
White	G6-990	G8-990	M2-990
White Cap	G6-113	G8-113	-

PREMIUM FINISHES			
COLOR NAME	1" .006 GAUGE	1" .008 GAUGE	2" .008 GAUGE
Bright Aluminum	G6-190	G8-190	M2-190
Brushed Aluminum	G6-034	G8-034	M2-034
Brushed Aluminum Perforated	-	G8-034P	-
Brushed Nickel Texture	-	G8-262	-
Brushed Patina	G6-996	G8-996	-
Café Noir	G6-993	G8-993	-
Champagne Mist	-	G8-995	-
China Blue	G6-637	G8-637	-
Copperite	-	G8-915	-
Dark Bronze Perforated	-	G8-994P	-
Garnet Red	G6-275	G8-275	-
Low Gloss Black	G6-892	G8-892	M2-892
Matte Alabaster	G6-991	G8-991	-
Matte Mushroom	G6-992	G8-992	-
Quartz	-	G8-1392	-
Rich Earth	-	G8-384	M2-384
Royal Navy	G6-685	G8-685	-
Sherwood Green	G6-590	G8-590	-
Snow Gloss	G6-110	G8-110	-
Sprig	G6-919	G8-919	-

*For Premium Finishes, a surcharge will be applied. Please refer to the price chart for more information.*

## FEATURES AND OPTIONS

	<b>Essentials Collection</b>	<b>Prime Collection</b>	<b>Macro Collection</b>
	<b>1"</b>	<b>1"</b>	<b>2"</b>
# of Colors	36	46	20
Slat Gauge	0.006	0.008	0.008
Headrail Size	1-1/4" X 1-1/2"	1-1/4" X 1-1/2"	2-1/4" X 1-1/2"
Headrail Gauge	0.024	0.024	0.024
Bottomrail	1-1/2" x 1-1/8"	1-1/2" x 1-1/8"	2" x 1-1/8"
Cord Size	1.4 mm	1.4 mm	1.4 mm
Ladder Spacing	22 mm	22 mm	42 mm
Wand	Clear, Standard	Clear, Standard	Clear, Standard
<b>OPTIONS</b>			
2 on 1 Headrail	✓	✓	✓
Control Positions (L or R)	✓	✓	✓
Box Brackets	✓	✓	✓
Hidden Brackets	✓	✓	✓
Dust Resistant Finish	✓	✓	✓
Channel Valance	✓	✓	✓
Integrated Valance	✓	✓	✓
Heavy Duty Headrail			✓
Push Button Bottomrail	✓	✓	✓
Hold-down Brackets	✓	✓	✓
Spacer Blocks*	✓	✓	✓
Tile Cut-Out**	✓	✓	✓

\* Used for outside mount blinds only to clear obstructions, such as window moldings.

\*\* Tilt Cut-Outs are only available for blinds over 31", maximum 1" on each side.

### INTEGRATED VALANCE



### HIDDEN BRACKET INSTALLATION

Hidden Installation Brackets

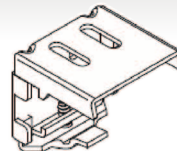

### CHANNEL VALANCE



### BOX BRACKET INSTALLATION

Box Installation Brackets

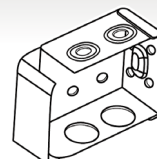

# PRODUCT SPECIFICATIONS

SIZE SPECIFICATIONS	Essentials / Prime Collections		Macro Collection
	1" .006 GAUGE / .008 GAUGE		2" .008 GAUGE
Slat width	1"		2"
Minimum width (NET)	10-1/2"		10-1/2"
Minimum height	12"		12"
Maximum width of a single blind	120"		120"
Maximum height	84"		84"
Maximum width 2 on 1 headrail	144"		144"
Center tilt only - Net Width	10 1/2" to 12-3/8"		10 1/2" to 12-3/8"
Left or right tilt only - Net width	12-1/2" or greater		12-1/2" or greater

FINISHED DIMENSIONS	1" .006 GAUGE / .008 GAUGE		2" .008 GAUGE
	Inside Mount (IB) Headrail	- 1/2"	
Inside Mount (IB) Slat	- 1/2"		- 1/2"
Outside Mount (OB) Headrail	Ordered Width		- 1/4"
Outside Mount (OB) Slat	Ordered Width		Ordered Width
Blind Height	Ordered Height		Ordered Height

\*\*NOTE: Measurements represent difference of total headrail or slat width (including endcaps) from ordered width

MOUNTING REQUIREMENTS	1" .006 GAUGE / .008 GAUGE			2" .008 GAUGE		
	Inside Mount Minimum Depth	Inside Mount Flush	Outside Mount (Wall Surface)	Inside Mount Minimum Depth	Inside Mount Flush	Outside Mount (Wall Surface)
No Valance						
Hidden Bracket	7/8"	1-3/4"	5/8"	n/a	n/a	n/a
Box Bracket	1"	1-3/4"	1-3/8"	n/a	n/a	n/a
With Valance						
Hidden Bracket	7/8"	2-1/4"	5/8"	n/a	n/a	n/a
Box Bracket	1"	2-1/4"	1-3/8"	1-1/8"	2-7/8"	1-3/4"

STACKING HEIGHTS	1" .006 GAUGE / .008 GAUGE		2" .008 GAUGE
	Blind Height		
Stacks to:			
36"	3-7/8"		5-1/4"
48"	4-1/4"		5-1/2"
60"	4-5/8"		5-3/4"
72"	5"		6"
84"	5-3/8"		6-1/4"

Return Lengths	1" .006 GAUGE / .008 GAUGE		2" .008 GAUGE
	Inside Mount	No Returns	
Outside Mount	1-3/4"		2-7/8"

## WAND LENGTHS

1" Blinds	
Wand Length	Blind Height
12"	12" to 22"
20"	22-1/8" to 37"
30"	37-1/8" to 52"
40"	52-1/8" to 67"
50"	67-1/8" to 82"
60"	82-1/8" to 84"

Optional Lengths: 70", 78", 90"

2" Blinds	
Wand Length	Blind Height
12"	12" to 24"
20"	24-1/8" to 36"
24"	36-1/8" to 48"
36"	48-1/8" to 60"
48"	60-1/8" to 75"
60"	75-1/8" to 84"

Optional Lengths: 72" and 84"

## LADDER PLACEMENT

1" Blinds	
Finished Width	# of Ladders
Up to 36"	2
36-1/8" to 60"	3
60-1/8" to 84"	4
84-1/8" to 108"	5
108-1/8" to 120"	6

2" Blinds	
Finished Width	# of Ladders
Up to 46-1/2"	2
46-5/8" to 80-1/2"	3
80-5/8" to 114-1/2"	4
114-5/8" to 120"	5

## CONTROL LOCATIONS

1" Metals	Width (Net)	Single Blind	2 on 1 (Left Blind)	2 on 1 (Right Blind)
	10-1/2" to 12-3/8"	C (Only)	C (Only)	C (Only)
12-1/2" or greater		L or R		

2" Metals	Width (Net)	Single Blind	2 on 1 (Left Blind)	2 on 1 (Right Blind)
	10-1/2" to 12-3/8"	Center Tilt Only	C (Only)	C (Only)
12-1/2" or greater		L or R		

# CORDLESS LIFT & LOCK™ BOTTOMRAIL COLOR CHART



The Cordless Lift & Lock™ operating system comes with a coordinating aluminum bottomrail in the color listed below.

NOTE: Color matched metal blinds are made of a variety of materials, extruded aluminum, rolled steel and several different plastics. Colors can differ slightly between the different materials.

COLOR NAME Solid Finishes	1" Blinds		Cordless Lift & Lock Bottomrail		2" Blinds		Cordless Lift & Lock Bottomrail	
	1" .006 GAUGE	1" .008 GAUGE	Color	Color #	2" .008 GAUGE	Color	Color #	
Alabaster	G6-002	G8-002	Alabaster	002	M2-002	Alabaster	002	
Antique	G6-973	G8-973	Alabaster	002	M2-973	Antique White	973	
Beige	G6-186	G8-186	Beige	186	-			
Black	G6-048	G8-048	Black	048	M2-048	Black	048	
Canvas	G6-830	G8-830	Alabaster	002	M2-830	Alabaster	002	
Cashmere	G6-997	G8-997	Cashmere / Silver Cloud	318	-			
Chalk White	G6-885	G8-885	Gloss White	110	M2-885	Chalk White / Flex White	885	
Dark Bronze	G6-994	G8-994	Bronze	064	M2-994	Bronze	064	
Evening Snow	-	G8-385	Pearl / Linen Flirt	127	-			
Malibu Sand	G6-316	G8-316	Malibu Sand	449	-			
Mercury	G6-276	G8-276	Mercury	276	M2-276	Silverado	276	
Mushroom	G6-365	G8-365	Mushroom	478	M2-365	Mushroom	476	
Pearl	G6-974	G8-974	Pearl / Linen Flirt	127	M2-974	Antique White	973	
Pebble	G6-999	G8-999	Pebble	999	-			
Pewter Gray	G6-405	G8-405	Pebble	999	-			
Polar Bear	G6-116	G8-116	Snow Gloss White	110	M2-116	Chalk White / Flex White	885	
Pure White	G6-125	G8-125	Pure White / White	125	-			
Raw Umber	G6-887	G8-887	Raw Umber / Umber	820	M2-887	Bronze	064	
Sand	G6-310	G8-310	Sand / Fawn	205	M2-310	Sand / Fawn	205	
Seattle Gray	G6-860	G8-860	Seattle Gray	860	-			
Smokey Gray	G6-443	G8-443	Squirrel Gray	426	-			
Squirrel Gray	G6-998	G8-998	Squirrel Gray	426	M2-998	Squirrel Gray	426	
U.N. Gray	-	G8-870	U.N Gray / Dark Gray	039	M2-870	Dark Gray	396	
Vanilla	-	G8-148	Alabaster	002	M2-148	Alabaster	002	
White	G6-990	G8-990	Snow Gloss White	110	M2-990	Chalk White / Flex White	885	
White Cap	G6-113	G8-113	Pearl / Linen Flirt	127	-			
COLOR NAME Premium Finishes	1" .006 GAUGE	1" .008 GAUGE	Color	Color #	2" .008 GAUGE	Color	Color #	
Bright Aluminum	G6-190	G8-190	Bright Aluminum	058	M2-190	Natural	058	
Brushed Aluminum	G6-034	G8-034	Bright Aluminum	058	M2-034	Natural	058	
Brushed Aluminum Perforated	-	G8-034P	Bright Aluminum	058	-			
Brushed Nickel Texture	-	G8-262	Bright Aluminum	058	-			
Brushed Patina	G6-996	G8-996	Brushed Patina	996	-			
Café Noir	G6-993	G8-993	Café Noir	993	-			
Champagne Mist	-	G8-995	Champagne Mist	995	-			
China Blue	G6-637	G8-637	China Blue	395	-			
Copperite	-	G8-915	Copperite	915	-			
Dark Bronze Perforated	-	G8-994P	Bronze	064	-			
Garnet Red	G6-275	G8-275	Garnet Red	448	-			
Low Gloss Black	G6-892	G8-892	Black	048	M2-892	Black	048	
Matte Alabaster	G6-991	G8-991	Alabaster	002	-			
Matte Mushroom	G6-992	G8-992	Mushroom	478	-			
Quartz	-	G8-1392	White	125	-			
Rich Earth	-	G8-384	Rich Earth / Milk Chocolate	097	M2-384	Rich Earth / Milk Chocolate	097	
Royal Navy	G6-685	G8-685	Royal Navy / Blue Blue	181	-			
Sherwood Green	G6-590	G8-590	Sherwood Green / Hunter Green	413	-			
Snow Gloss	G6-110	G8-110	Gloss White	110	-			
Sprig	G6-919	G8-919	Sprig / Julep	919	-			

NOTE: Bottomrail colors are pre-selected. Hardware color override is not available.